

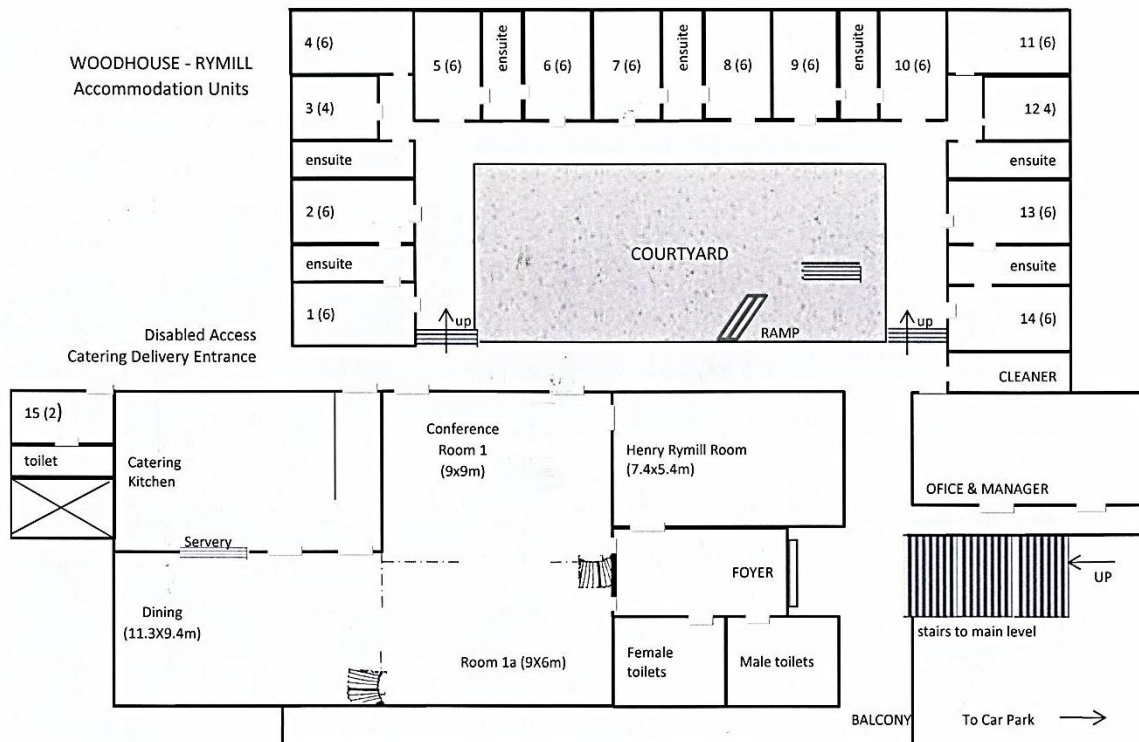

Woodhouse Accommodation option: **Rymill**

Spring Gully Road, PICCADILLY, SA 5151 Phone: 8339 3333 Fax: 8370 9704

www.woodhouse.org.au



Dimensions: Dining room (11.3 x 9.4m) - Room 1a (9x6m) - Conference 1 (9x9m) – Henry Rymill Room (7.4x5.4m). Note: Dining, Conference Room 1 and Room 1a are either open planned or spate rooms.

Sleeping: Bed total = 82 Bunk beds, 15 rooms (room 15 and ensuite bathroom available for disabled) Mattresses supplied; guests to bring all linen, pillows and other requirements – all rooms heated.

Ablutions: each two rooms are separated by double ensuite bathroom - Guest to supply own towels and bath mats.

Kitchen / Dining: Fully equipped commercial kitchen / dining room catering for 80 people. Commercial cookers and grill plates, fridge, freezer, microwave, crockery & cutlery (No wine glasses)

Other Features: Extensive training rooms, Group rooms, Air-conditioned, private courtyard and downstairs the BBQ under cover.